

All dimensions are imperial unless stated.

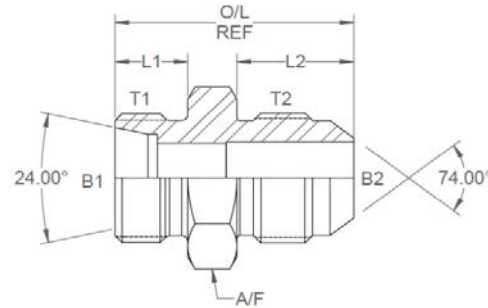

	T1	T2	B1	B2	L1	L2	O/L	A/F
01-06S04J	M14 x 1.5	7/16	0.172	0.172	0.472	0.550	1.260	19mm
01-08S04J	M16 x 1.5	7/16	0.172	0.172	0.520	0.550	1.340	22mm
01-08S06J	M16 x 1.5	9/16	0.197	0.297	0.520	0.556	1.340	19mm
01-10S06J	M18 x 1.5	9/16	0.297	0.297	0.520	0.556	1.340	22mm
01-10S08J	M18 x 1.5	3/4	0.276	0.391	0.472	0.657	1.360	22mm
01-12S06J	M20 x 1.5	9/16	0.297	0.297	0.472	0.556	1.360	22mm
01-12S08J	M20 x 1.5	3/4	0.315	0.391	0.472	0.657	1.519	22mm
01-12S10J	M20 x 1.5	7/8	0.396	0.484	0.550	0.758	1.680	1.000
01-14S08J	M22 x 1.5	3/4	0.391	0.391	0.551	0.657	1.470	27mm
01-16S10J	M24 x 1.5	7/8	0.484	0.484	0.551	0.758	1.639	27mm
01-20SX212J	M30 x 2	1-1/16	0.609	0.609	0.630	0.864	1.973	32mm
01-25SX212J	M36 x 2	1-1/16	0.609	0.609	0.709	0.864	1.973	41mm
01-30SX216J	M42 x 2	1-5/16	0.844	0.844	0.787	0.911	2.180	50mm
01-30SX220J	M42 x 2	1-5/8	0.984	1.078	0.787	0.958	2.230	50mm
01-38SX220J	M52 x 2	1-5/8	1.078	1.078	0.866	0.958	2.324	55mm

Add -CWNR to part number for complete with nuts and rings, i.e. 01-06S04J-CWNR.

DESIGN DETAILS AND SPECIFICATIONS SUBJECT TO CHANGE WITHOUT PRIOR NOTICE - Whilst every effort has been made to ensure the accuracy of the information supplied herein, Burnett & Hillman cannot be held responsible for any errors or omissions (E&OE)

A/F dimensions are imperial unless stated.

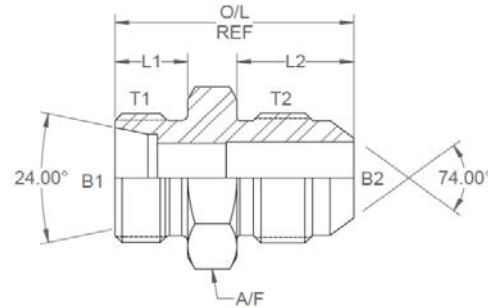

	T1	T2	B1	B2	L1	L2	O/L	A/F
01-06S04J	M14 x 1.5	7/16	4.37	4.37	11.99	13.97	32.00	19mm
01-08S04J	M16 x 1.5	7/16	4.37	4.37	13.21	13.97	34.04	22mm
01-08S06J	M16 x 1.5	9/16	5.00	7.54	13.21	14.12	34.04	19mm
01-10S06J	M18 x 1.5	9/16	7.54	7.54	13.21	14.12	34.04	22mm
01-10S08J	M18 x 1.5	3/4	7.01	9.93	11.99	16.69	34.54	22mm
01-12S06J	M20 x 1.5	9/16	7.54	7.54	11.99	14.12	34.54	22mm
01-12S08J	M20 x 1.5	3/4	8.00	9.93	11.99	16.69	38.58	22mm
01-12S10J	M20 x 1.5	7/8	10.06	12.29	13.97	19.25	42.67	1.000
01-14S08J	M22 x 1.5	3/4	9.93	9.93	14.00	16.69	37.34	27mm
01-16S10J	M24 x 1.5	7/8	12.29	12.29	14.00	19.25	41.63	27mm
01-20SX212J	M30 x 2	1-1/16	15.47	15.47	16.00	21.95	50.11	32mm
01-25SX212J	M36 x 2	1-1/16	15.47	15.47	18.01	21.95	50.11	41mm
01-30SX216J	M42 x 2	1-5/16	21.44	21.44	19.99	23.14	55.37	50mm
01-30SX220J	M42 x 2	1-5/8	24.99	27.38	19.99	24.33	56.64	50mm
01-38SX220J	M52 x 2	1-5/8	27.38	27.38	22.00	24.33	59.03	55mm

Add -CWNR to part number for complete with nuts and rings, i.e. 01-06204J-CWNR.

DESIGN DETAILS AND SPECIFICATIONS SUBJECT TO CHANGE WITHOUT PRIOR NOTICE - Whilst every effort has been made to ensure the accuracy of the information supplied herein, Burnett & Hillman cannot be held responsible for any errors or omissions (E&OE)