

All dimensions are imperial unless stated.

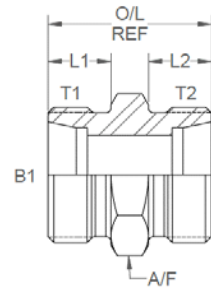

	T1	T2	B1	L1	L2	O/L	A/F
01-06L	M12 x 1.5	M12 x 1.5	0.157	0.394	0.394	0.944	12mm
01-08L	M14 x 1.5	M14 x 1.5	0.236	0.394	0.394	0.984	14mm
01-10L	M16 x 1.5	M16 x 1.5	0.315	0.433	0.433	1.062	17mm
01-12L	M18 x 1.5	M18 x 1.5	0.394	0.433	0.433	1.102	19mm
01-15L	M22 x 1.5	M22 x 1.5	0.472	0.472	0.472	1.181	24mm
01-18L	M26 x 1.5	M26 x 1.5	0.591	0.472	0.472	1.22	27mm
01-22L	M30 x 2	M30 x 2	0.748	0.551	0.551	1.378	32mm
01-28L	M36 x 2	M36 x 2	0.945	0.551	0.551	1.417	41mm
01-35L	M45 x 2	M45 x 2	1.181	0.63	0.63	1.614	46mm
01-42L	M52 x 2	M52 x 2	1.417	0.63	0.63	1.693	55mm

Add -CWNR to part number for complete with nuts and rings, i.e. 01-06L-CWNR.

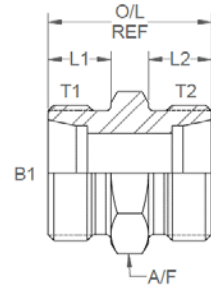

	T1	T2	B1	L1	L2	O/L	A/F
01-06L	M12 x 1.5	M12 x 1.5	4	10	10	24	12mm
01-08L	M14 x 1.5	M14 x 1.5	6	10	10	25	14mm
01-10L	M16 x 1.5	M16 x 1.5	8	11	11	27	17mm
01-12L	M18 x 1.5	M18 x 1.5	10	11	11	28	19mm
01-15L	M22 x 1.5	M22 x 1.5	12	12	12	30	24mm
01-18L	M26 x 1.5	M26 x 1.5	15	12	12	31	27mm
01-22L	M30 x 2	M30 x 2	19	14	14	35	32mm
01-28L	M36 x 2	M36 x 2	24	14	14	36	41mm
01-35L	M45 x 2	M45 x 2	30	16	16	41	46mm
01-42L	M52 x 2	M52 x 2	36	16	16	43	55mm

Add -CWNR to part number for complete with nuts and rings, i.e. 01-06L-CWNR.