

All dimensions are imperial unless stated.

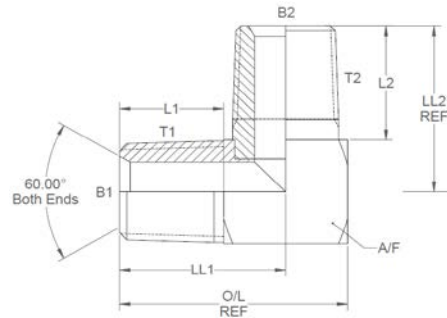

	T1	T2	B1	B2	L1	L2	O/L	LL1	LL2	A/F
08000	1/8	1/8	0.188	0.188	0.38	0.52	0.88	0.63	0.77	0.5
08001	1/4	1/4	0.25	0.25	0.625	0.7	1.3	0.962	1.012	0.625
08009	3/8	1/4	0.375	0.25	0.69	0.7	1.465	1.077	1.075	0.75
07097	1/2	1/4	0.5	0.25	0.84	0.7	1.84	1.403	1.137	0.875
08002	3/8	3/8	0.375	0.375	0.69	0.72	1.465	1.077	1.095	0.75
07098	1/2	3/8	0.5	0.375	0.84	0.72	1.84	1.403	1.157	0.875
07099	3/8	1/2	0	0	0	0	0	0	0	0
08003	1/2	1/2	0.5	0.5	0.84	0.943	1.84	1.34	1.38	0.875
08004	3/4	3/4	0.687	0.687	0.95	0.95	2.1	1.525	1.512	1.125
08005	1	1	0.843	0.843	1.25	1.315	2.75	2	2.002	1.375
08006	1-1/4	1-1/4	1.203	1.203	1.5	1.49	3.15	2.237	2.365	1.75
08007	1-1/2	1-1/2	1.312	1.312	1.6	1.64	3.65	2.625	2.64	2
08008	2	2	1.781	1.75	1.7	1.7	4.45	3.2	2.95	2.5

A/F dimensions are imperial unless stated.

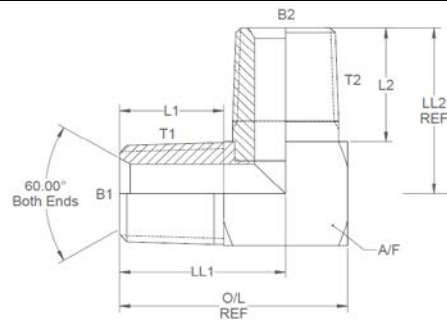

	T1	T2	B1	B2	L1	L2	O/L	LL1	LL2	A/F
08000	1/8	1/8	4.78	4.78	9.65	13.21	22.35	16	19.56	0.5
08001	1/4	1/4	6.35	6.35	15.88	17.78	33.02	24.43	25.7	0.625
08009	3/8	1/4	9.53	6.35	17.53	17.78	37.21	27.36	27.31	0.75
07097	1/2	1/4	12.7	6.35	21.34	17.78	46.74	35.64	28.88	0.875
08002	3/8	3/8	9.53	9.53	17.53	18.29	37.21	27.36	27.81	0.75
07098	1/2	3/8	12.7	9.53	21.34	18.29	46.74	35.64	29.39	0.875
07099	3/8	1/2	0	0	0	0	0	0	0	0
08003	1/2	1/2	12.7	12.7	21.34	23.95	46.74	34.04	35.05	0.875
08004	3/4	3/4	17.45	17.45	24.13	24.13	53.34	38.74	38.4	1.125
08005	1	1	21.41	21.41	31.75	33.4	69.85	50.8	50.85	1.375
08006	1-1/4	1-1/4	30.56	30.56	38.1	37.85	80.01	56.82	60.07	1.75
08007	1-1/2	1-1/2	33.32	33.32	40.64	41.66	92.71	66.68	67.06	2
08008	2	2	45.24	44.45	43.18	43.18	113.03	81.28	74.93	2.5