

All dimensions are imperial unless stated.

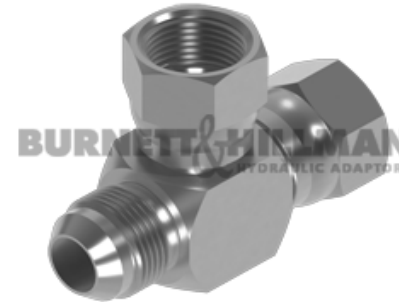

	T1	T2	T3	B1	B2	B3	L1	O/L	LL1	LL2	LL3	A/F	A/F1	A/F2
02057	7/16	7/16	7/16	0.172	0.172	0.176	0.64	1.94	0.952	0.625	0.93	0.5	0.562	0.562
02058	1/2	1/2	1/2	0.234	0.203	0.203	0.64	2.1	1.015	0.704	1.04	0.625	0.625	0.625
02059	9/16	9/16	9/16	0.297	0.297	0.297	0.65	2.17	1.037	0.747	1.09	0.625	0.687	0.687
02060	3/4	3/4	3/4	0.391	0.391	0.391	0.775	2.6	1.22	0.933	1.4	0.875	0.875	0.875
02061	7/8	7/8	7/8	0.484	0.484	0.5	0.875	3.05	1.437	1.097	1.6	1	1	1
02062	1-1/16	1-1/16	1-1/16	0.593	0.593	0.593	0.99	3.43	1.627	1.214	1.775	1.125	1.25	1.25
02063	1-5/16	1-5/16	1-5/16	0.812	0.812	0.812	1.125	3.8	1.837	1.322	1.925	1.375	1.5	1.5

A/F dimensions are imperial unless stated.

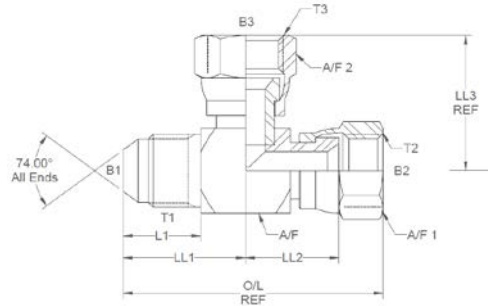
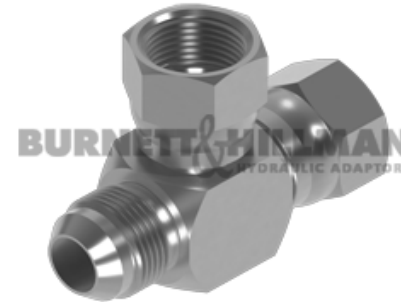
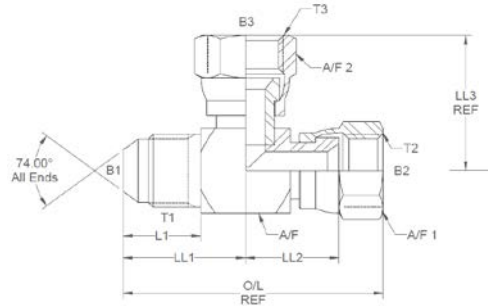

	T1	T2	T3	B1	B2	B3	L1	O/L	LL1	LL2	LL3	A/F	A/F1	A/F2
02057	7/16	7/16	7/16	4.37	4.37	4.47	16.26	49.28	24.18	15.88	23.62	0.5	0.562	0.562
02058	1/2	1/2	1/2	5.94	5.16	5.16	16.26	53.34	25.78	17.88	26.42	0.625	0.625	0.625
02059	9/16	9/16	9/16	7.54	7.54	7.54	16.51	55.12	26.34	18.97	27.69	0.625	0.687	0.687
02060	3/4	3/4	3/4	9.93	9.93	9.93	19.69	66.04	30.99	23.7	35.56	0.875	0.875	0.875
02061	7/8	7/8	7/8	12.29	12.29	12.7	22.23	77.47	36.5	27.86	40.64	1	1	1
02062	1-1/16	1-1/16	1-1/16	15.06	15.06	15.06	25.15	87.12	41.33	30.84	45.09	1.125	1.25	1.25
02063	1-5/16	1-5/16	1-5/16	20.62	20.62	20.62	28.58	96.52	46.66	33.58	48.9	1.375	1.5	1.5