

All dimensions are imperial unless stated.

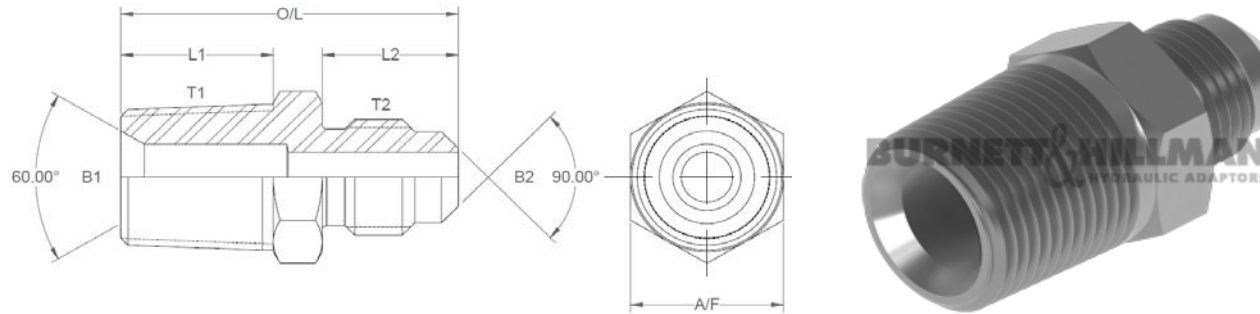

	T1	T2	B1	B2	L1	L2	O/L	A/F
01050	1/8	7/16	0.188		0.38	0.5	1.06	0.5
01051	1/8	1/2	0.188	0.219	0.38	0.56	1.15	0.5
01052	1/4	7/16	0.25	0.188	0.56	0.5	1.24	0.562
01053	1/4	1/2	0.25	0.219	0.56	0.56	1.33	0.562
01054	1/4	5/8	0.25	0.281	0.56	0.62	1.395	0.687
01055	1/4	3/4	0.25	0.406	0.56	0.75	1.63	0.812
01056	3/8	7/16	0.375	0.188	0.56	0.5	1.46	0.687
01058	3/8	5/8	0.375	0.281	0.56	0.62	1.48	0.687
01057	3/8	3/4	0.375	0.406	0.56	0.75	1.635	0.812
01059	3/8	7/8	0.375	0.5	0.5	0.88	1.81	0.875
01060	1/2	5/8	0.5	0.281	0.75	0.62	1.67	22mm
01061	1/2	3/4	0.5	0.406	0.75	0.75	1.825	22mm
01062	1/2	7/8	0.5		0.75	0.88	2	0.875
01063	1/2	1-1/16	0.5	0.625	0.75	1	2.18	1.125
01065	3/4	3/4	0.635	0.406	0.75	0.75	1.825	1.1
01066	3/4	7/8	0.635	0.5	0.75	0.88	2	1.1
01067	3/4	1-1/16	0.547		0.75	1	2.18	1.125

A/F dimensions are imperial unless stated.

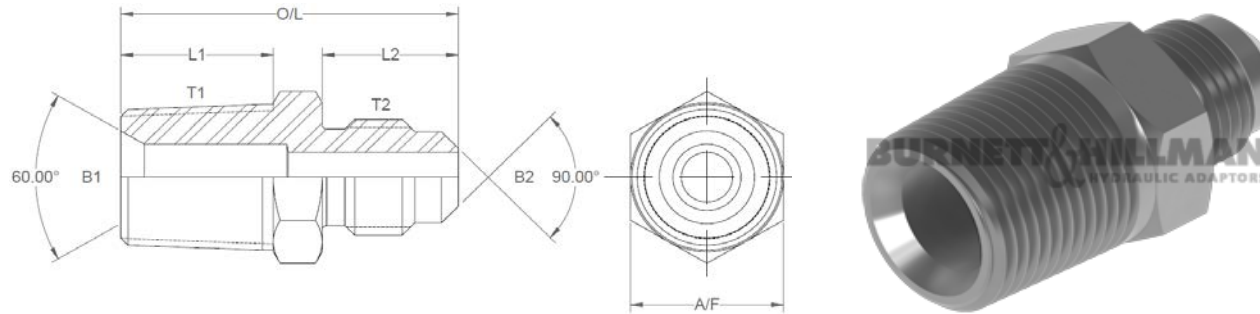

	T1	T2	B1	B2	L1	L2	O/L	A/F
01050	1/8	7/16	4.78		9.65	12.70	26.92	0.5
01051	1/8	1/2	4.78	5.56	9.65	14.22	29.21	0.5
01052	1/4	7/16	6.35	4.78	14.22	12.70	31.50	0.562
01053	1/4	1/2	6.35	5.56	14.22	14.22	33.78	0.562
01054	1/4	5/8	6.35	7.14	14.22	15.75	35.43	0.687
01055	1/4	3/4	6.35	10.31	14.22	19.05	41.40	0.812
01056	3/8	7/16	9.53	4.78	14.22	12.70	37.08	0.687
01058	3/8	5/8	9.53	7.14	14.22	15.75	37.59	0.687
01057	3/8	3/4	9.53	10.31	14.22	19.05	41.53	0.812
01059	3/8	7/8	9.53	12.70	12.70	22.35	45.97	0.875
01060	1/2	5/8	12.70	7.14	19.05	15.75	42.42	22mm
01061	1/2	3/4	12.70	10.31	19.05	19.05	46.36	22mm
01062	1/2	7/8	12.70		19.05	22.35	50.80	0.875
01063	1/2	1-1/16	12.70	15.88	19.05	25.40	55.37	1.125
01065	3/4	3/4	16.13	10.31	19.05	19.05	46.36	1.1
01066	3/4	7/8	16.13	12.70	19.05	22.35	50.80	1.1
01067	3/4	1-1/16	13.89		19.05	25.40	55.37	1.125